

2510

REV	DESCRIPTION	DATE
-----	-------------	------

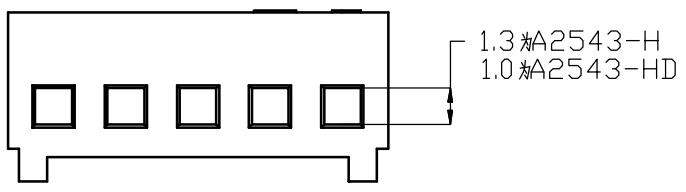

Poles	Part No.		Dimensions mm	
			A	B
2	A2543-H02	2510-2Y	2.54	5.76
3	A2543-H03	2510-3Y	5.08	8.30
4	A2543-H04	2510-4Y	7.62	10.84
5	A2543-H05	2510-5Y	10.16	13.38
6	A2543-H06	2510-6Y	12.70	15.92
7	A2543-H07	2510-7Y	15.24	18.46
8	A2543-H08	2510-8Y	17.78	21.00
9	A2543-H09	2510-9Y	20.32	23.54
10	A2543-H10	2510-10Y	22.86	26.08
11	A2543-H11	2510-11Y	25.40	28.62
12	A2543-H12	2510-12Y	27.94	31.16
13	A2543-H13	2510-13Y	30.48	33.70
14	A2543-H14	2510-14Y	33.02	36.24
15	A2543-H15	2510-15Y	35.56	37.78
16	A2543-H16	2510-16Y	38.10	41.32

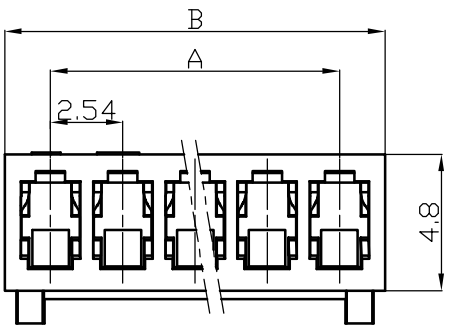
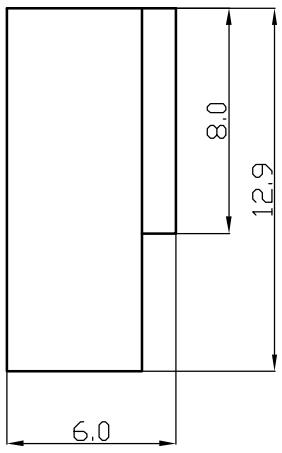
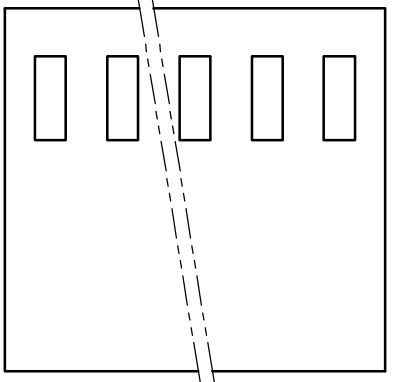
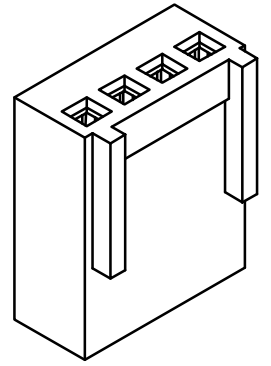

Design Units	SIZE	页码	
METRIC	A4		
Part No			
2510-NY			